

# DOC 303

For tractors 70-90 hp (5 m / 5,7 m)



Hydraulic hedge mower with side shift and mechanical release safety device for tractors HP 70/90 and weight 3000/3500 kg, suitable for working on local and trunk roads and farms.

<b>DOC 303</b>	<b>5.0</b>	<b>5.7</b>
A mm	5.000	5.700
B mm	5.200	5.900
C mm	4.100	4.800
D mm	3.200	3.900
E mm	4.000	4.700
F mm	550	550

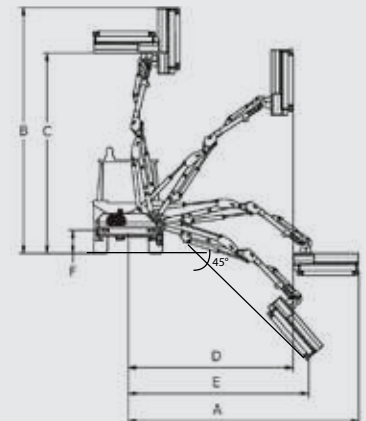

### Rotor with shackle (exchangeable tools)

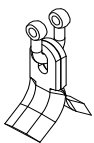

**KC2**  
Ø max 2 cm  
**STANDARD EQUIPMENT**

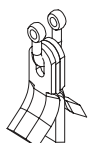

**KC3**  
Ø max 2 cm

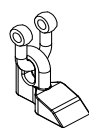

**HC1**  
Ø max 4 cm

### Rotor with bolt (exchangeable tools)



**KF2**  
Ø max 3 cm



**KF3**  
Ø max 3 cm



**HF3**  
Ø max 6 cm



Tools n. 16 kits per rotor

Arm mower	DOC 303 5.0	DOC 303 5.7
<b>Extension</b> E mm	5.000	5.700
<b>Weight</b> kg	820	880
<b>Oil tank</b> L	150	150
<b>Head</b> model	30.3	30.3
<b>Pump</b> l/min	80+20	80+20
<b>Hydraulic Motor</b> HP [kW]	45 (33)	45 (33)

### Tractor

<b>Power</b> HP [kW]	70/90 (51/6)	70/90 (51/6)
<b>3-point linkage</b> Cat.	Cat. 1-2	Cat. 1-2
<b>Weight</b> kg	3.000	3.500
<b>Width</b> m	2	2,2
<b>PTO</b> rpm	540	540

### Technical features and standard equipment

- Frame - 1<sup>st</sup> arm - 2<sup>nd</sup> arm in structural steel ST 52
- Three points hitch 2<sup>nd</sup> category
- Oil tank 150 l
- Double gear pump group 3+2 - 80+20 l/min
- Bidirectional hydraulic motor HP 45 power
- Distributor with remote controls with mm 3000 flexible cables
- Self-levelling floating system
- Feeler roller recordable on 3 positions
- Head rotating angle 200° with upper attachment
- Helicoidal rotor with jointed cut blade KC2
- Rotor turning at 3000 rpm
- Fixing tie-rods
- Cardan joint
- Rear underrun protection with lights
- Flail head mm 1050 MODEL 30.3 TTD 105 with direct transmission

### Accessories on request

- Nitrogen accumulator for 1<sup>st</sup> arm suspension
- Heat exchanger
- Electric distributor with joystick
- Electric command of the rotor
- Proportional power-assisted with joystick
- Rear flail head hitch
- Tie rods adapter Cat. 2
- Flail head mm 1250 - n. 20 kits of tools per rotor

### Terminal tools

In replacement of the standard mulcher

p.82



**HEDGE CUTTING BAR**

BF15

p.83



**PRUNING SHEAR BAR**

BTZ5 15  
BTZ5 18  
BTZ10 16  
BTZ10 19  
BTZ10 22

p.84



**FOREST CUTTING DISC BAR**

BD2  
BD3

p.85



**DITCH CLEANER**

PF60